

OWNER'S CERTIFICATE AND DEDICATION

KNOW ALL MEN BY THESE PRESENTS:

That W.E.P. LAND HOLDINGS, L.L.C., AN OKLAHOMA LIMITED LIABILITY COMPANY and KG Holdings, L.P., are the owners of all the property contained and included in the Plat of REPLAT OF LOT 7, BLOCK 1, WEST END PONTE ADDITION PHASE II, SECTION 2, on addition to the City of Yukon, Canadian County, Oklahoma, being a part of the Southwest Quarter (SW/4) of Section Twenty-nine (29), Township Twelve (12) North, Range Five (5) West of the Indian Meridian, Canadian County, Oklahoma, and has caused the said premises to be surveyed and platted into Lots, Blocks, Streets, and Easements as shown on said plat, which said plat (consisting of one sheet) represents a careful survey of all property contained and included therein and is hereby adopted as the Plat of REPLAT OF LOT 7, BLOCK 1, WEST END PONTE ADDITION PHASE II, SECTION 2, on addition to the City of Yukon, Canadian County, Oklahoma.

It further certifies that it does hereby dedicate all streets and avenues, parks and public facilities, and easements as shown on the annexed Plat of REPLAT OF LOT 7, BLOCK 1, WEST END PONTE ADDITION PHASE II, SECTION 2, on addition to the City of Yukon, Canadian County, Oklahoma, to the use of the public for public highways, streets, and drainage and utility easements for their heirs, executors, administrators, successors, and assigns forever, and shall cause the same to be released from all encumbrances so that title is clear.

W.E.P. LAND HOLDINGS, L.L.C., AN OKLAHOMA LIMITED LIABILITY COMPANY

Ken R. McGee
Ken R. McGee, Manager

STATE OF OKLAHOMA) SS

COUNTY OF Canadian

Before me, the undersigned Notary Public in and for said County and State, on this 17th day of October, 2007, personally appeared Ken R. McGee, to me known to be the identical person who subscribed, as Manager of W.E.P. LAND HOLDINGS, L.L.C., AN OKLAHOMA LIMITED LIABILITY COMPANY, acknowledged to me that he executed the same as the free and voluntary act and deed of himself and said Corporation or Partnership.

My commission Expires: 9-7-11 Notary Public: Susan BibleCommission No.: 99014863

KG HOLDINGS, L.P., A TEXAS LIMITED PARTNERSHIP

Ken R. McGee
KG Investments, Inc., General Partner
Ken R. McGee, President

STATE OF OKLAHOMA) SS

COUNTY OF Canadian

Before me, the undersigned Notary Public in and for said County and State, on this 17th day of October, 2007, personally appeared Ken R. McGee, to me known to be the identical person who subscribed, as President of KG HOLDINGS, L.P., A TEXAS LIMITED PARTNERSHIP, by KG Investments, Inc., General Partner, acknowledged to me that he executed the same as the free and voluntary act and deed of himself and said Corporation or Partnership.

My commission Expires: 9-7-11 Notary Public: Susan BibleCommission No.: 99014863

SURVEYOR'S CERTIFICATE

I, Shaun Christopher Axton, a Registered Professional Land Surveyor, in the State of Oklahoma, do hereby certify that I have made a careful survey of the foregoing property designated REPLAT OF LOT 7, BLOCK 1, WEST END PONTE ADDITION PHASE II, SECTION 2, on addition to the City of Yukon, Canadian County, Oklahoma, and that the above foregoing Plat is a correct representation of said survey.

Witness my hand and seal this 17th day of October, 2007.

Shaun Christopher Axton
Shaun Christopher Axton, P.L.S. 1494

STATE OF OKLAHOMA) SS

COUNTY OF Oklahoma

Before me, the undersigned, a Notary Public in and for said County and State on this 17th day of October, 2007, personally appeared Shaun Christopher Axton, to me known to be the identical person who subscribed and acknowledged to me that he executed the same as his free and voluntary act and deed for uses and purposes therein set forth. Given under my hand and seal the day and year last above written.

My commission Expires: 3/21/11 Notary Public: Scott KufnerCommission No.: 07002617

BONDED ABSTRACTOR'S CERTIFICATE

The undersigned, duly qualified and lawfully bonded abstractor of title in and for Canadian and the State of Oklahoma, certifies that the records of said County show that the title to the land shown on the annexed Plat of REPLAT OF LOT 7, BLOCK 1, WEST END PONTE ADDITION PHASE II, SECTION 2, on addition to the City of Yukon, Canadian County, Oklahoma, is vested in W.E.P. LAND HOLDINGS, L.L.C., AN OKLAHOMA LIMITED LIABILITY COMPANY and KG HOLDINGS, L.P. and that on this 17th day of October, 2007, there are no actions pending or judgments of any nature in any court or on file with the clerk of said land or owner thereof, that the taxes are paid for the year 2006 and prior years, that there are no outstanding tax sales certificates against said land and no tax deeds are issued to any person, that there are no liens, mortgages, or other encumbrances of any kind against the land included in the annexed plat, except mortgages and liens of record.

In witness whereof, said Bonded Abstractor has caused this instrument to be executed this 23rd day of October, 2007.

WARRANTY TITLE & ABSTRACT, INC.

Jay J. Schiller
Jay J. Schiller, Vice-President

STATE OF OKLAHOMA) SS

COUNTY OF Canadian

Before me, the undersigned, a Notary Public in and for said County and State on this 23rd day of October, 2007, personally appeared Jay J. Schiller, to me known to be the identical person who subscribed and acknowledged to me that she executed the same as her free and voluntary act and deed for uses and purposes therein set forth. Given under my hand and seal the day and year last above written.

My commission Expires: 3-7-11 Notary Public: Estelle CashCommission No.: 03002019

COUNTY TREASURER'S CERTIFICATE

I, David T. Rodcliff, do hereby certify that I am the duly elected, qualified and acting County Treasurer of Canadian County, State of Oklahoma; that the tax records of said county show all taxes are paid for the year 2006 and prior years on the land shown on the annexed Plat of REPLAT OF LOT 7, BLOCK 1, WEST END PONTE ADDITION PHASE II, SECTION 2, on addition to the City of Yukon, Canadian County, Oklahoma; that the required statutory security has been deposited in the office of the County Treasurer, guaranteeing the payment of the current year's taxes.

In witness whereof, said County Treasurer has caused this instrument to be executed, this 23rd day of October, 2007.

David T. Rodcliff
David T. Rodcliff, County Treasurer

CITY PLANNING COMMISSION APPROVAL

It is acknowledged by the City of Yukon Planning Commission that the Plat of REPLAT OF LOT 7, BLOCK 1, WEST END PONTE ADDITION PHASE II, SECTION 2, on addition to the City of Yukon, Canadian County, Oklahoma, has been approved at a meeting on the 17th day of October, 2007.

Joe Sewell
Joe Sewell, Planning Commission Chair

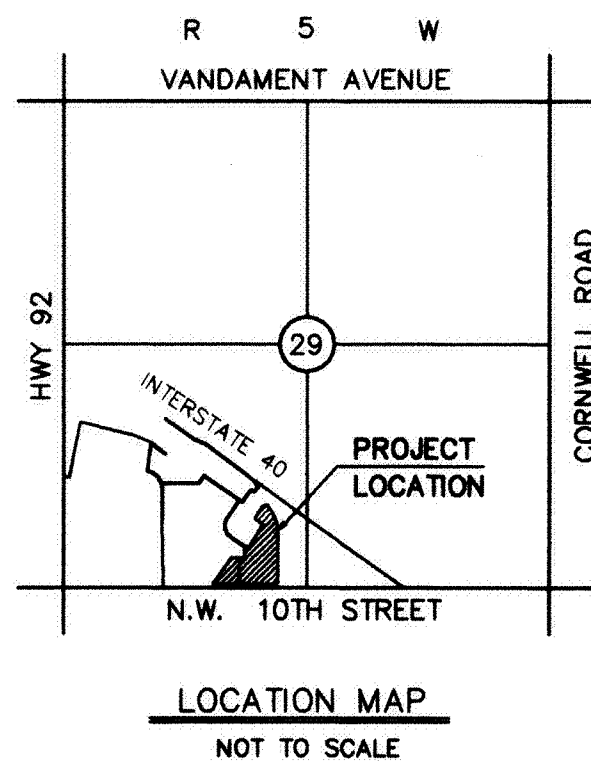

REPLAT OF LOT 7, BLOCK 1, WEST END PONTE ADDITION PHASE II SECTION 2

A PART of THE SW/4 of SECTION 29, T 12 N, R 5 W, I.M.
THE CITY OF YUKON, CANADIAN COUNTY, OKLAHOMA

Doc#P 2007 37
Bk&Pg:PL 9 208
Filed:10-23-2007
03:44:33 PM
Canadian County, OK

LA

PL

CITY OF YUKON COUNCIL APPROVAL

BE IT HEREBY RESOLVED by the Council of the City of YUKON, that the Plat of REPLAT OF LOT 7, BLOCK 1, WEST END PONTE ADDITION PHASE II, SECTION 2, on addition to the City of Yukon, Canadian County, Oklahoma, is hereby approved and the dedications shown hereon are hereby approved and accepted.

ADOPTED by the Council of the City of Yukon, Oklahoma this 17th day of October, 2007.

Patricia G. Hargis
Patricia G. Hargis, City Clerk

SUBORDINATION OF MORTGAGE:

In consideration of the plotting of property shown on the annexed map Plat of REPLAT OF LOT 7, BLOCK 1, WEST END PONTE ADDITION PHASE II, SECTION 2, on addition to the City of Yukon, Canadian County, Oklahoma, and other good and valuable considerations, receipt of which is hereby acknowledged Midfirst Bank, Oklahoma, does hereby subordinate, relinquish and forever discharge a certain mortgage made by W.E.P. LAND HOLDINGS, L.L.C., AN OKLAHOMA LIMITED LIABILITY COMPANY and KG HOLDINGS, L.P. dated the 17th day of October, 2007 which is recorded in Book 92417 Page 37, Canadian County, Oklahoma, insofar as the same covers all property dedicated for streets, alleys, parks, easements or other public use, as shown on said map.

Witness my hand and seal this 17 day of October, 2007.

Roy Cogen
Roy Cogen, Vice-President

STATE OF OKLAHOMA) SS

COUNTY OF Oklahoma

Before me, the undersigned, a Notary Public in and for said County and State on this 17th day of October, 2007, personally appeared Roy Cogen, Vice-President, to me known to be the identical person who subscribed and acknowledged to me that he executed the same as his free and voluntary act and deed for uses and purposes therein set forth. Given under my hand and seal the day and year last above written.

My commission Expires: 9-7-11 Notary Public: Susan BibleCommission No.: 99014863

NOTES:

1. The bearing of South 89°59'58" West as shown on the South line of the Southwest Quarter of Section 29 was used as the basis of bearing for this survey.
2. This plat of survey meets the Oklahoma Minimum Standards for the Practice of Land Surveying as adopted by the Oklahoma State Board of Registration for Professional Engineers and Land Surveyors.
3. Monuments set at all lot corners.
4. Sidewalks are required on all commercial lot frontages, except where noted otherwise.
5. A Property Owners Association will be responsible for maintenance and expenses of the common area and detention pond.

LEGAL DESCRIPTION

A tract of land lying in the Southwest Quarter (S.W. 1/4) of Section Twenty-nine (29), Township Twelve (12) North, Range Five (5) West of the Indian Meridian, Canadian County, Oklahoma, being all of Lot Seven (7), Block One (1), WEST END PONTE ADDITION PHASE II, SECTION 2, and being more particularly described as follows:

COMMENCING at the Southwest corner of the Southwest Quarter (S.W. 1/4) of Section 29;

THENCE South 89°59'58" West, along the South line of the Southwest Quarter (S.W. 1/4), a distance of 1022.48 feet;

THENCE North 00°00'00" West, a distance of 50.00 feet to the POINT OF BEGINNING, said point being the Southwest corner of Lot Seven (7), Block One (1), REPLAT OF LOT 7, BLOCK 1, WEST END PONTE ADDITION PHASE II, SECTION 2;

THENCE along the Westerly line of Lot Seven (7), the following 9 calls:

North 34°42'47" East, a distance of 346.11 feet;

South 90°00'00" East, a distance of 145.93 feet;

North 00°00'00" East, a distance of 135.04 feet;

South 58°29'53" East, a distance of 16.89 feet to a point of intersection with a tangent curve;

On a curve to the left having a radius of 40.00 feet (said curve subtended by a chord which bears North 76°28'30" East, a distance of 56.60 feet) an arc distance of 62.87 feet to a point of intersection with a tangent line;

North 31°28'53" East, a distance of 264.97 feet;

North 58°29'53" West, a distance of 110.05 feet;

North 31°28'53" East, a distance of 166.54 feet;

North 71°29'22" East, a distance of 50.00 feet to a point of intersection with a non-tangent curve,

said point on the Easterly line of Lot 7;

THENCE on a curve to the right, along the Easterly line of Lot 7, having a radius of 470.00 feet (said curve subtended by a chord which bears South 20°30'59" East, a distance of 326.99 feet) an arc distance of 333.98 feet to a point of intersection with a tangent line;

THENCE South 00°00'35" East, along the Easterly line of Lot 7, a distance of 534.20 feet;

THENCE South 44°55'12" West, along the Easterly line of Lot 7, a distance of 35.31 feet to a point on the South line of Lot 7;

THENCE South 89°59'58" West, along the South line of Lot 7, a distance of 682.34 feet to the POINT OF BEGINNING.

Said tract of land contains an area of 305,092 square feet or 7.0039 acres, more or less.

CURVE NO. 13 R = 470.00' Δ = 222°53' L = 431.9' T = 0.77 C = 19.53'	CURVE NO. 16 R = 80.00' Δ = 41°24' L = 43.1' T = 22.53' C = 42.18'	CURVE NO. 17 R = 30.00' Δ = 48°123' L = 48.1' T = 13.42' C = 24.48'	CURVE NO. 20 R = 40.00' Δ = 80°314' L = 80.3' T = 40.04' C = 56.80'
CURVE NO. 25 R = 530.00' Δ = 43°542' L = 368.64' T = 209.28' C = 369.31'	CURVE NO. 26 R = 500.00' Δ = 43°542' L = 378.08' T = 197.43' C = 367.27'	CURVE NO. 27 R = 470.00' Δ = 43°542' L = 353.61' T = 188.86' C = 346.24'	CURVE NO. 28 R = 4277.84' Δ = 0°15'35" L = 193.83' T = 08.91' C = 193.83'
CURVE NO. 29 R = 530.00' Δ = 40°343' L = 378.30' T = 197.61' C = 370.32'	CURVE NO. 30 R = 530.00' Δ = 211°00' L = 20.34' T = 20.34'	CURVE NO. 31 R = 470.00' Δ = 40°42'50" L = 333.98' T = 174.58' C = 328.99'	

GRAPHIC SCALE

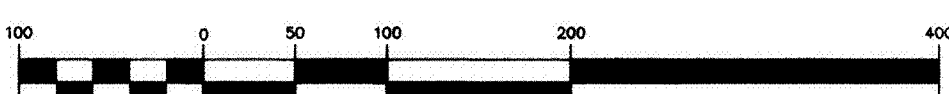

(IN FEET)

1 inch = 100 ft.

C.H. GUERNSEY & COMPANY
Engineers • Architects • Consultants
5555 North Grand Boulevard, Oklahoma City, OK 73112
Phone (405) 416-8100, Civil Fax (405) 416-8114

Mark Deal & Associates, P.C.
1684 S.W. 86th STREET, SUITE C
Oklahoma City, OK 73159
405.681.3325 voice - 405.681.3316 fax
axton@pripis.net
Certificate of Authorization No. 3045
Expires June 30, 2009

